

REPLACEMENT

1. IF NECESSARY, REPLACE OIL PUMP BODY OIL SEAL

- (a) Using a screwdriver and hammer, drive out the oil seal.
- (b) Coat the lip of a new oil seal with MP grease.

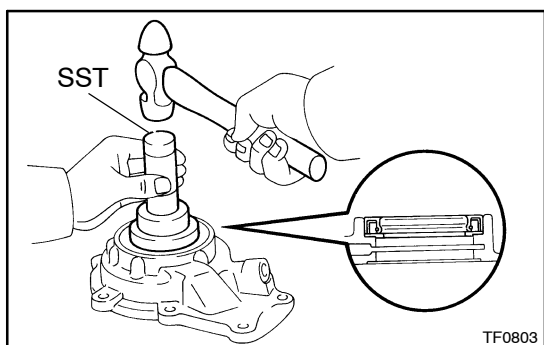

- (c) Using SST and a hammer, drive in a new oil seal.
SST 09223-22010
Oil seal drive in depth: 0.3 – 0.7 mm (0.012 – 0.028 in.)

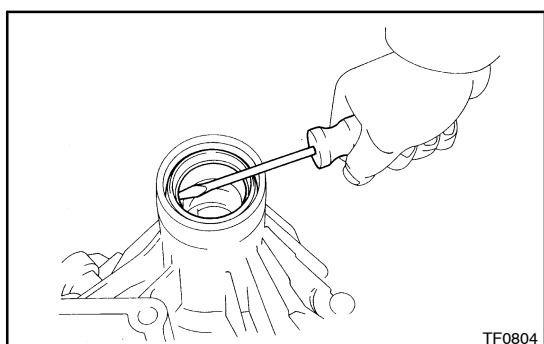

2. IF NECESSARY, REPLACE FRONT CASE OIL SEAL

- (a) Using a screwdriver, pry out the oil seal.
- (b) Coat the lip of a new oil seal with MP grease.

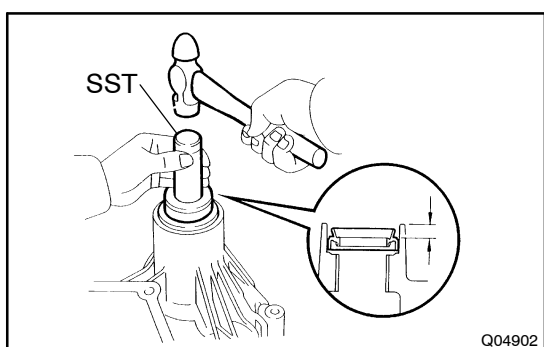

- (c) Using SST and a hammer, drive in a new oil seal.
SST 09223-22010
**Oil seal drive in depth:
11.0 – 12.0 mm (0.433 – 0.472 in.)**

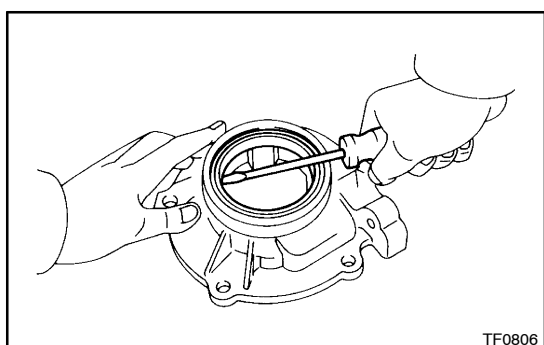

3. IF NECESSARY, REPLACE EXTENSION HOUSING OIL SEAL

- (a) Using a screwdriver, pry out the oil seal and remove the dust deflector.
- (b) Install a new dust deflector.
- (c) Coat the lip of a new oil seal with MP grease.

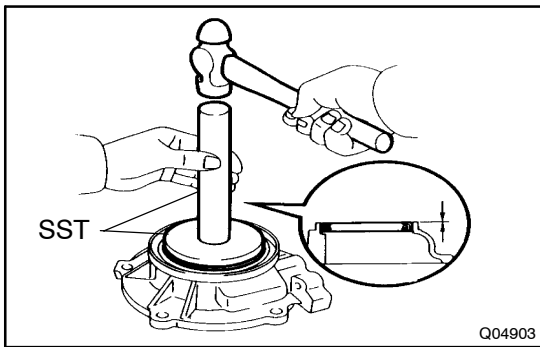

- (d) Using SST and a hammer, drive in a new oil seal.

SST 09950-60020 (09951-00720),

09950-70010 (09951-07150)

Oil seal drive in depth: 0 – 1.6 mm (0 – 0.063 in.)

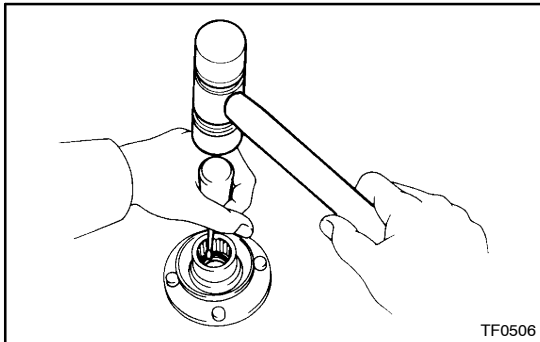

4. IF NECESSARY, REPLACE COMPANION FLANGE OIL SEAL

- (a) Using a screwdriver and hammer, driver out the oil seal.
 (b) Coat the lip of a new oil seal with MP grease.

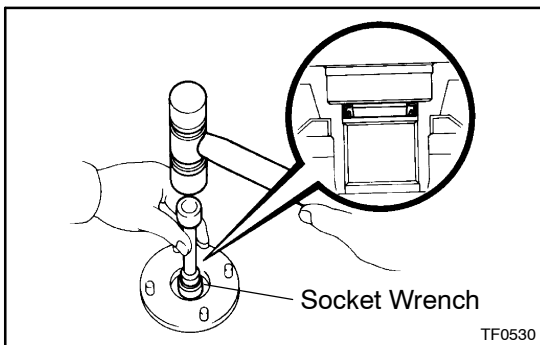

- (c) Using a socket wrench (22 mm) and hammer, drive in a new oil seal.

Oil seal drive in depth:

16.3 – 17.8 mm (0.642 – 0.701 in.)